

POWER TAKE-OFF

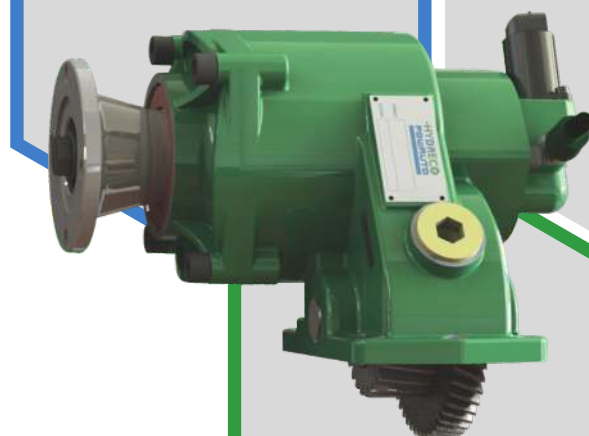

PTO Technical Data

Product Code	PB151-1A23 with MK1183
Torque (Nm/ft lb)	300/221
PTO Ratio	1.32
Approximate Bare Weight (kg/lb)	10.0/22.05
Output Shaft Rotation	Anticlockwise
Suitable Transmission Model	Eaton FS6209/ES1109

**PTO Technical Data**

Product Code	PB151-1A23 with MK1198
Torque (Nm/ft lb)	300/221
PTO Ratio	1.32
Approximate Bare Weight (kg/lb)	11.18/26.65
Output Shaft Rotation	Anticlockwise
Suitable Transmission Model	Eaton FS-6306/FS-6406/ ES-9306A/9306SD

PTO Technical Data

Product Code	PA406 PTO with MK1137B
Torque (Nm/ft lb)	440/324
PTO Ratio	0.72
Approximate Bare Weight (kg/lb)	17.0/37.48
Output Shaft Rotation	Clockwise
Suitable Transmission Model	Eaton ES11109 Transmission

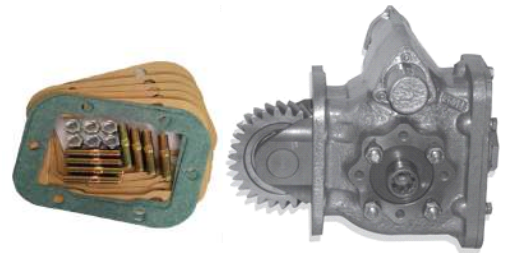
**PTO Technical Data**

Product Code	PB151-4 with MK1192
Torque (Nm/ft lb)	300/221
PTO Ratio	1.32
Approximate Bare Weight (kg/lb)	9.3/20.5
Output Shaft Rotation	Anticlockwise
Suitable Transmission Model	ZF6S 850D/6S-36/6S-75



PTO Technical Data

Product Code	PB136A23 with MK118D
Torque (Nm/ft lb)	420/310
PTO Ratio	1
Approximate Bare Weight (kg/lb)	8.5/18.74
Output Shaft Rotation	Clockwise
Suitable Transmission Model	ZF-9S1110

PTO Technical Data

Product Code	PB151-2A23 with MK1201C
Torque (Nm/ft lb)	300/221
PTO Ratio	1.32
Approximate Bare Weight (kg/lb)	13.5/29.76
Output Shaft Rotation	Anticlockwise
Suitable Transmission Model	Volvo VT-2214B Manual Transmission



PTO Technical Data

Product Code	PB151-2A23 with MK1201D
Torque (Nm/ft lb)	300/221
PTO Ratio	1.32
Approximate Bare Weight (kg/lb)	13.2/29.1
Output Shaft Rotation	Anticlockwise
Suitable Transmission Model	Volvo AT-2612D I-shift Transmission

PTO Technical Data

Product Code	PA562HHL11AFL-Flanged Output
Torque (Nm/ft lb)	300/221
PTO Ratio	2.2
Approximate Bare Weight (kg/lb)	10.5/23.15
Output Shaft Rotation	Anticlockwise
Suitable Transmission Model	TATA GBS-550 Transmission

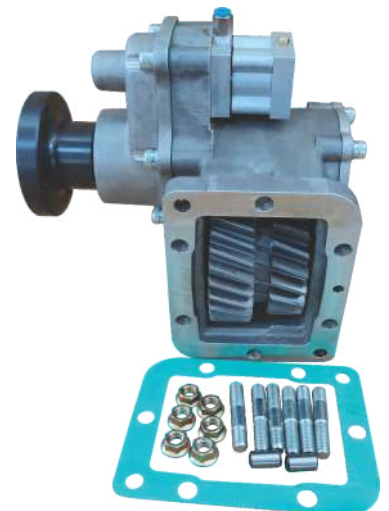

PTO Technical Data

Product Code	PA561SSL11A23 - MPH Type
Torque (Nm/ft lb)	250/184
PTO Ratio	1
Approximate Bare Weight (kg/lb)	9.1/20.06
Output Shaft Rotation	Clockwise
Suitable Transmission Model	TATA GBS-600 Transmission

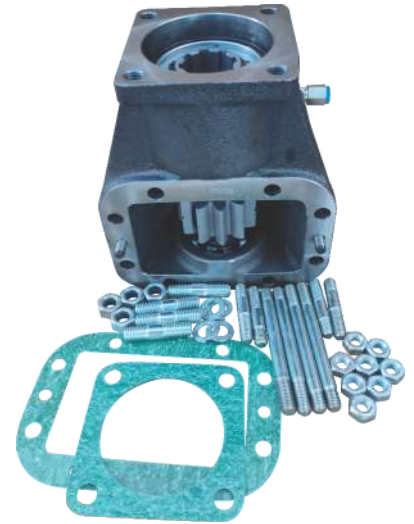

PTO Technical Data

Product Code	PA563SSL11A23 - V2 Type
Torque (Nm/ft lb)	350/258
PTO Ratio	1.25
Approximate Bare Weight (kg/lb)	16.8/37.04
Output Shaft Rotation	Anticlockwise
Suitable Transmission Model	TATA GBS-600 Transmission

PTO Technical Data

Product Code	PA559SSL11A23-MPH Type
Torque (Nm/ft lb)	250/184
PTO Ratio	1
Approximate Bare Weight (kg/lb)	9.1/20.06
Output Shaft Rotation	Clockwise
Suitable Transmission Model	TATA GBS-750 Transmission (Spur gear)



PTO Technical Data

Product Code	PA560HHL11A23-MPH Type
Torque (Nm/ft lb)	250/184
PTO Ratio	1
Approximate Bare Weight (kg/lb)	8.8/19.4
Output Shaft Rotation	Clockwise
Suitable Transmission Model	TATA GBS-750 Transmission (Helical gear)



PTO Technical Data

Product Code	PB136A23 PTO with MK1210
Torque (Nm/ft lb)	350/258
PTO Ratio	1
Approximate Bare Weight (kg/lb)	5.7/12.57
Output Shaft Rotation	Clockwise
Suitable Transmission Model	TATA GBS-950 Transmission

PTO Technical Data

Product Code	PB1150A23
Torque (Nm/ft lb)	450/332
PTO Ratio	1
Approximate Bare Weight (kg/lb)	10.5/23.15
Output Shaft Rotation	Clockwise
Suitable Transmission Model	TATA GBS-1150 Transmission

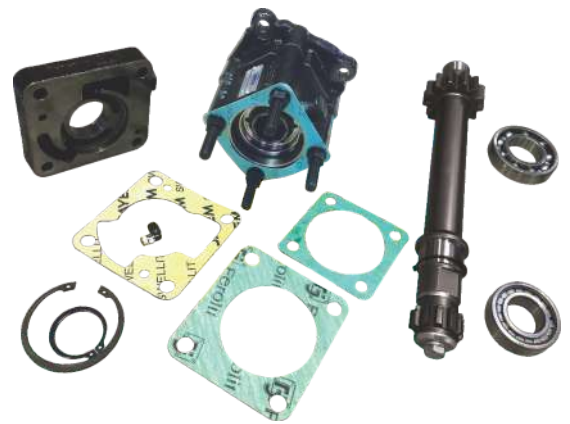

PTO Technical Data

Product Code	PB1152A23
Torque (Nm/ft lb)	350/258
PTO Ratio	1.32
Approximate Bare Weight (kg/lb)	9.5/20.94
Output Shaft Rotation	Anticlockwise
Suitable Transmission Model	Bharath Benz G-85 Transmission

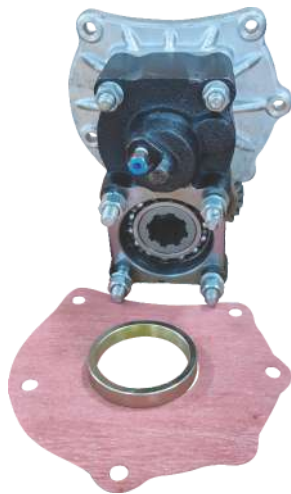

PTO Technical Data

Product Code	PB1151A23
Torque (Nm/ft lb)	500/369
PTO Ratio	1
Approximate Bare Weight (kg/lb)	6.9/15.21
Output Shaft Rotation	Clockwise
Suitable Transmission Model	Bharath Benz G-131 Transmission



Supported by a **worldwide network**



CONTACT INFORMATION

EMEA

GERMANY	Hydreco Hydraulics GmbH, Straelen (NRW)	+49 283494303-41	info-de@hydreco.com
ITALY	Hydreco Hydraulics Italia Srl, Vignola (MO)	+39 059 7700411	sales-it@hydreco.com
NORWAY	Hydreco Hydraulics Norway AS, Niittedal	+47 22909410	post-no@hydreco.com
UK	Hydreco Hydraulics Ltd, Poole, Dorset	+44 (0) 1202 627500	info-uk@hydreco.com

AMERICAS

USA	Hydreco	+1 704 295 7575	sales-us@hydreco.com
LATIN AMERICA	Inc, Rock Hill (SC)	+1 704 572 6266	sales-es@hydreco.com

APAC

AUSTRALIA	Hydreco	+61 2 9838 6800	sales-au@hydreco.com
AUSTRALIA	Hydreco Hydraulics Pty Ltd, Smeaton Grange (NSW)	+61 2 4647 6577	au-smeatongrange@hydreco.com
AUSTRALIA	Hydreco Hydraulics Pty Ltd, Welshpool (WA)	+61 8 9377 2211	reception-wa@hydreco.com
INDIA	Hydraulics Pty Ltd, Seven Hills (NSW)	+91 80 67656300	sales-in@hydreco.com
	Hydreco Hydraulics India Private Ltd, Bangalore		

